

MAY 1906  
**BISBEE**  
ARIZ.

**UPPER LOWELL**

WATER SYSTEM FOR FIRE PROTECTION  
SUPPLIED FROM SOUTHERN'S TANK  
AT LOWELL MINE. PRESSURE OVER  
100 LBS AT HIGHEST PORTION OF  
TOWN. 2 1/2" HOSE CARRIES WITH 200'  
2 1/2" HOSE EACH HAVE BEEN  
PURCHASED. DIMENSIONS AS SHOWN.

**BISBEE IMPROVEMENT  
CO'S. ELEC. LIGHT &  
ICE PLANT**  
POWER - STEAM - FUELED OIL.  
HIGH PLUMBS ON PRESSURES  
BUBBLES OF WATER ON ROOF.  
NUMBERING CHEM. EXTINGUISHERS  
410'S & 415'S AS SHOWN.  
LOCATED AT UPPER LOWELL

**CALUMET & ARIZONA CO'S  
HOISTON HOIST**  
POWER & HEAT - STEAM - LIGHTS ELEC.  
ELEV. OIL. WATER FROM 500' DEEP  
TANK. ELEV. 20' ABOVE SHUTT. TALLE  
FROM C. & A. MINE. IS CHEMICAL.  
EXTINGUISHERS. HOSE & 1 1/2" AS SHOWN.

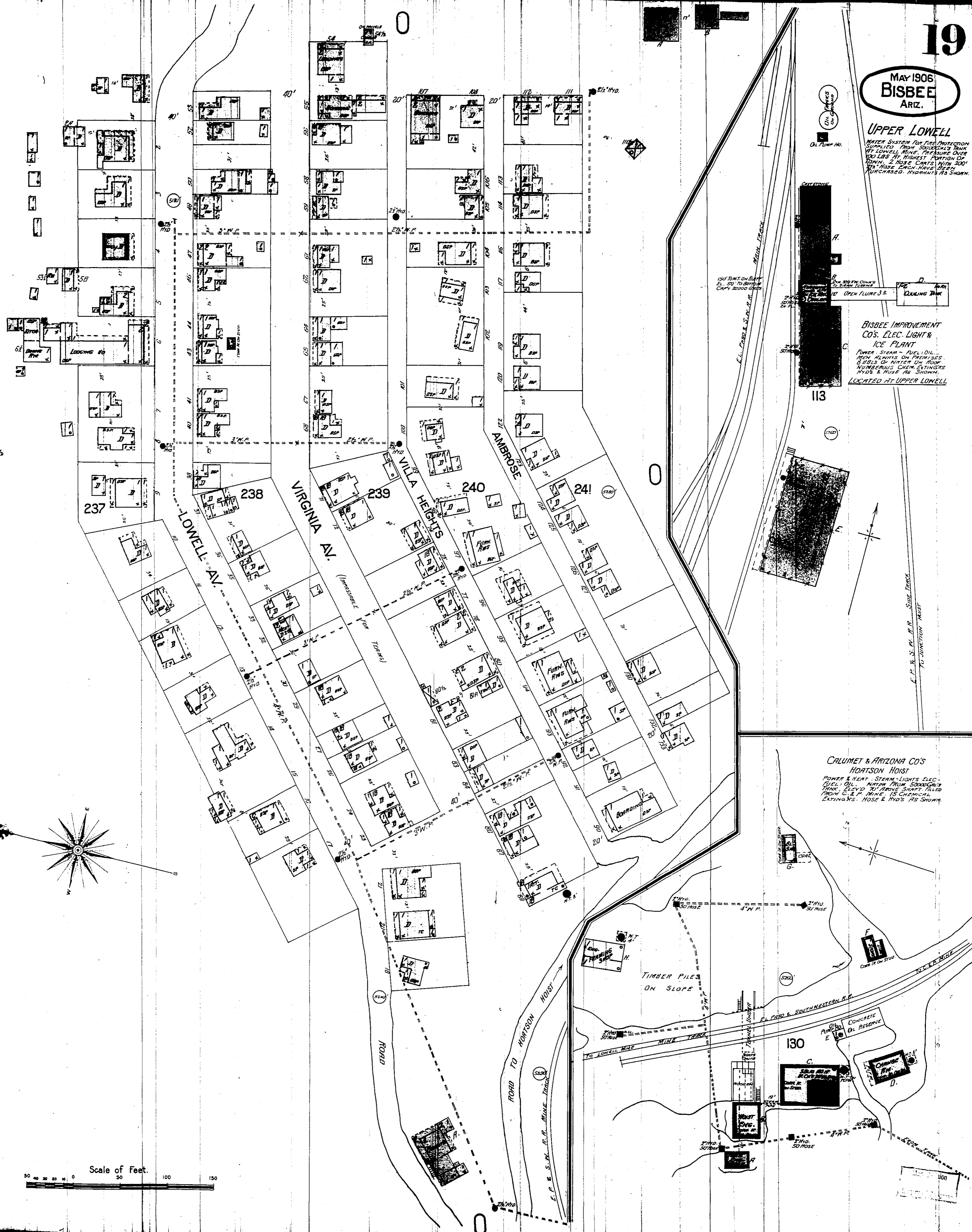

Scale of Feet.  
0 50 100 150