

APRIL 1904
DOUGLAS
ARIZ.

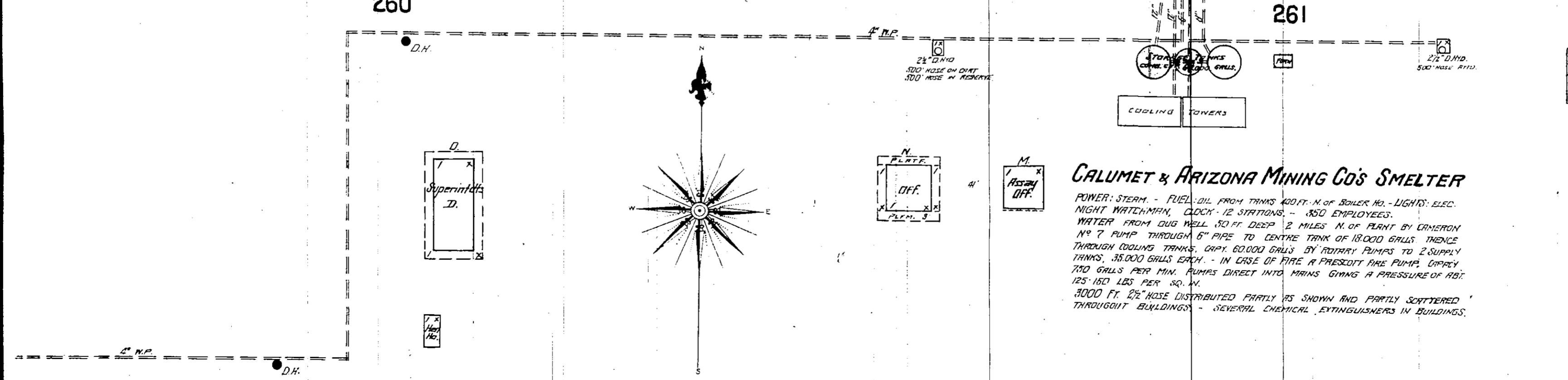
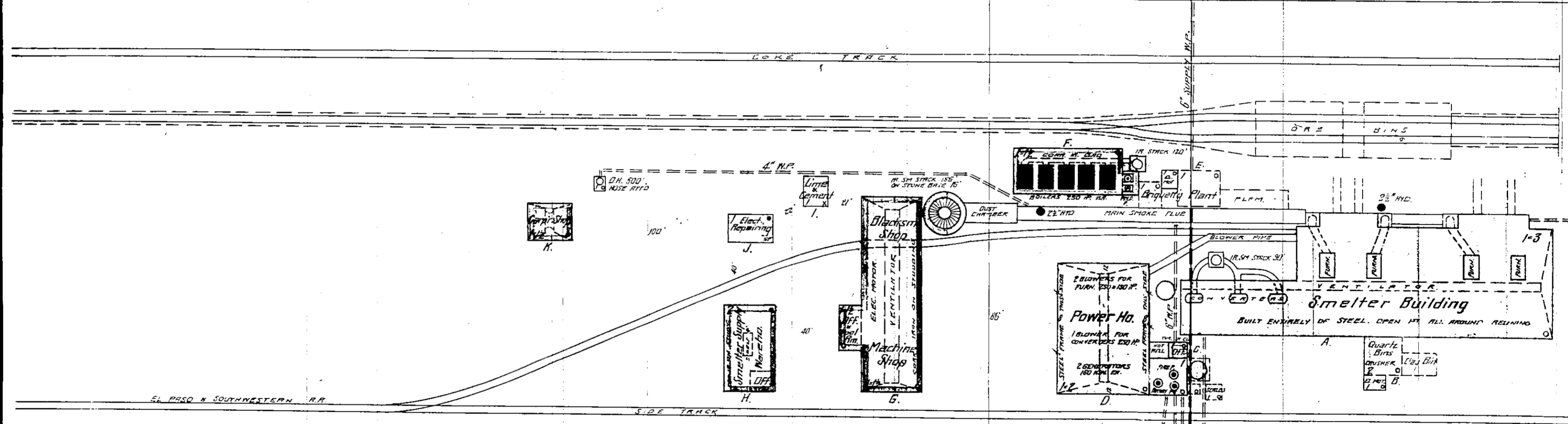
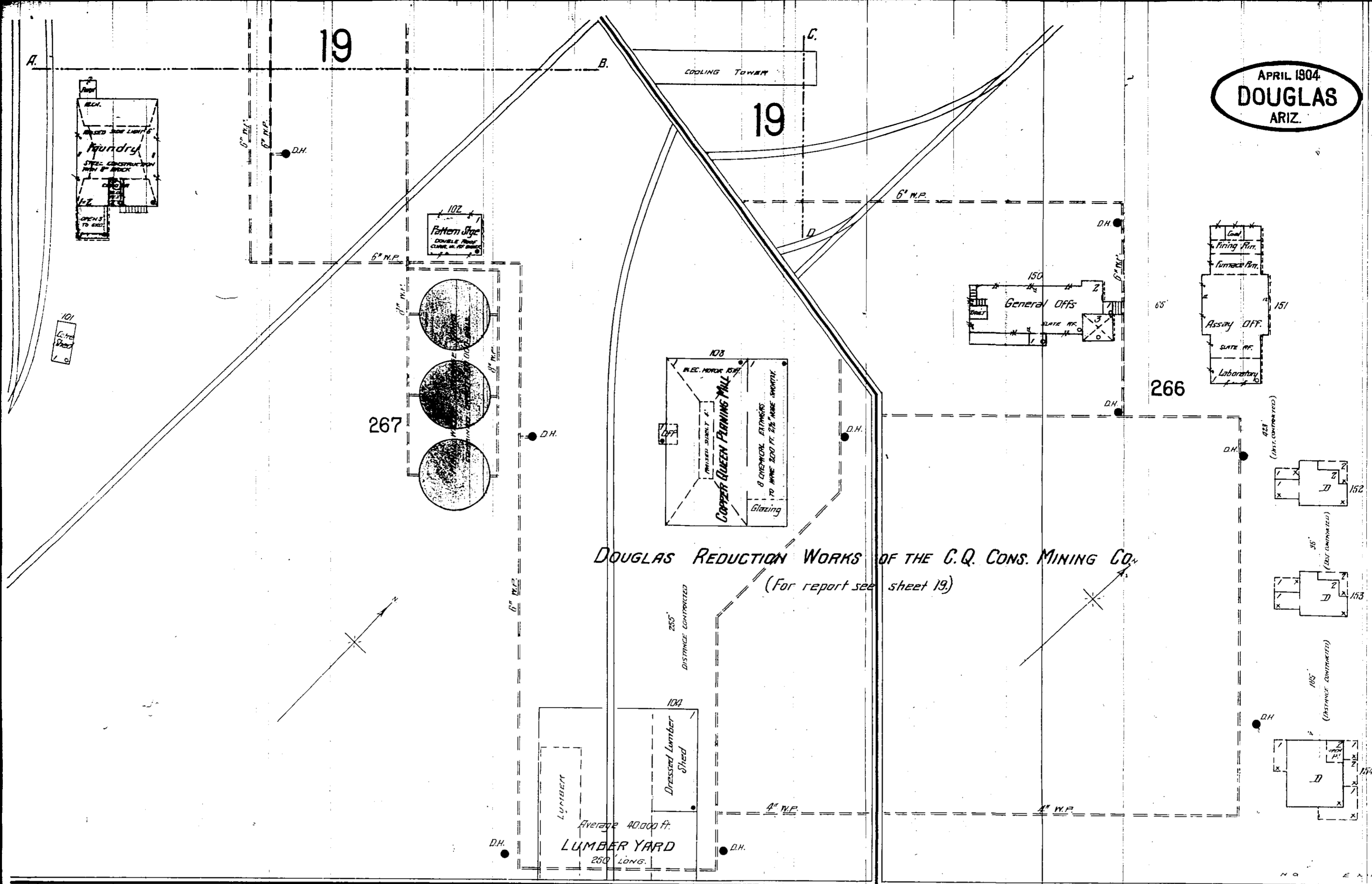

CALUMET & ARIZONA MINING CO'S SMELTER

POWER: STEAM - FUEL: OIL FROM TANKS 400 FT. N. OF BOILER NO. - LIGHTS: ELEC.
NIGHT WATCHMAN, CLOCK - 12 STRATIONS - 350 EMPLOYEES.
WATER FROM DUG WELL 50 FT. DEEP 2 MILES N. OF PLANT BY CAMERON
NO. 7 PUMP THROUGH 6" PIPE TO CENTRE TANK OF 18,000 GALLS. THENCE
THROUGH COOLING TANKS, CAPT. 60,000 GALLS BY PRIMARY PUMPS TO 2 SUPPLY
TANKS, 35,000 GALLS EACH. - IN CASE OF FIRE A PRESSURE FIRE PUMP, CAPREY
750 GALLS PER MIN. PUMPS DIRECT INTO MAINS GIVING A PRESSURE OF ABT.
125-150 LBS PER SQ. IN.
3000 FT. 1 1/2" HOSE DISTRIBUTED PARTLY AS SHOWN AND PARTLY SCATTERED
THROUGHOUT BUILDINGS - SEVERAL CHEMICAL EXTINGUISHERS IN BUILDINGS.

Located about 3 miles N.W. of Douglas Passenger Depot.

SCALE OF FEET.

