



Map Division  
OCT 22 1904  
Library of Congress

RECORDED  
INDEXED  
OCT 10 1904  
CITY OF GILBERT  
CLERK OF THE CITY

**KEY**

|   |   |
|---|---|
| ■ | FIRE WALL 6 IN. AB. ROOF.                 |
| ■ | " " 12 " " "                              |
| ■ | " " 18 " " "                              |
| ■ | FRAME PARTITION                           |
| ■ | OPENING & IRON DOORS                      |
| ■ | WINDOWS " " SHUTTERS                      |
| ■ | STABLE                                    |
| ■ | WINDOW IN 1 <sup>ST</sup> STORY           |
| ■ | " " 1 <sup>ST</sup> & 2 <sup>ND</sup> " " |
| ■ | " " 2 <sup>ND</sup> & 3 <sup>RD</sup> " " |
| ■ | BLOCKS COLORED YELLOW ARE FRAME           |
| ■ | RED " BRICK                               |
| ■ | BLUE " STONE                              |
| ■ | GREY " IRON                               |
| ■ | BROWN " TERRAZZO                          |
| ■ | GREEN " SPECIALS                          |
| ○ | MARBLE " ARE CLOTH LINED                  |
| ○ | INDICATE RELATIVE HEIGHTS                 |
| ○ | 10' FROM CENTER DUNNALLY                  |
| ○ | 5' FROM CENTER                            |
| ○ | PAVEMENT                                  |
| ○ | ALTERNATE STREET NOS ARE ACTUAL           |
| ○ | CONSISTENT " " ARBITRARY                  |
| ○ | BROWN LINE NEAR BLDG. WOOD CORNICE        |
| ○ | SOLID " " METAL                           |

**WATER REPORT:** WATER FROM 2 WELLS LOCATED 1 1/2 MI. S. OF COURT NO. 50 DEEP (BEING SUNK DEEPER) BY WASHINGTON DUPLEX PUMP, 3000 GALS PER HOUR, ALSO BY CAMERON ST. P. W.G.S. PUMPED THROUGH 4" & 6" SUPPLY PIPE TO RESERVOIR (BRICK CONCRETE) IN BLOCK NO. 7 ELEVATED 180' ABOVE BROAD ST. CAP. 150000 GALS. DISTRIBUTING PIPES 3" & 4". GRAVITY PRESSURE IN BUSINESS PART OF TOWN ABOUT 50 LBS. PER SQ. IN. PUMPS HAVE ALSO DIRECT CONNECTION WITH MAINS.

**FIRE DEPT.:** VOLUNTEER, 25 MEMBERS.  
2 HOSE CARTS WITH 500' 2 1/2" HOSE EACH. 500' 2 1/2" HOSE IN RESERVE.  
DRILLS MONTHLY.

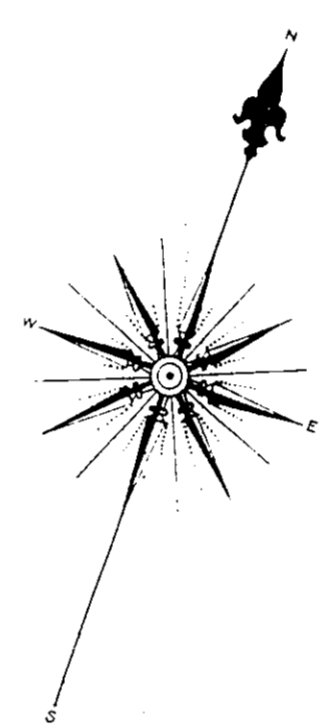
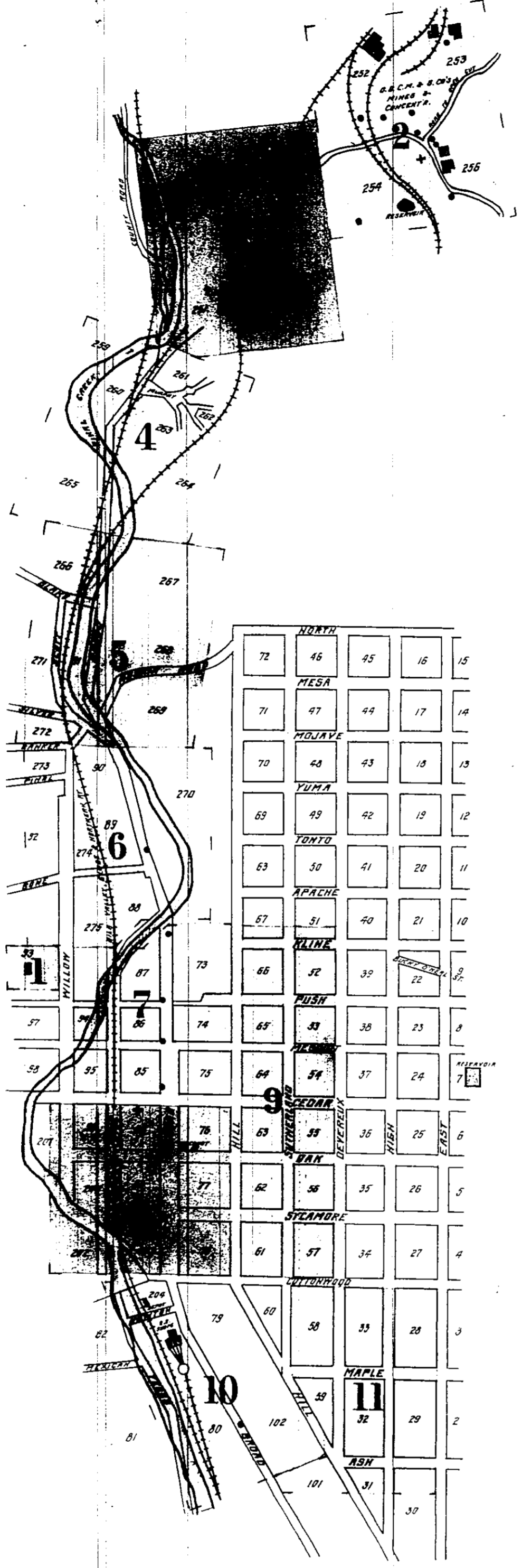

**INDEX.**

**SPECIALS.**

|   |  |    |
|---|--|----|
| B | Barclay, Higdon & Co.'s Livery                       | 7  |
| C | Catholic Church                                      | 8  |
|   | County Court House                                   | 8  |
| G | Gila Valley, Globe & Northern R. R. Shops            | 10 |
|   | Globe Electric Light Plant                           | 7  |
|   | Ice and Cold Storage Co.                             | 7  |
|   | Lumber Co.   | 6  |
| M | M. E. Church   | 8  |
| O | O. K. Corral and Feed                                | 7  |
|   | Old Dominion Commercial Co.                          | 7  |
|   | Copper Mining and Smelting Co., Hoisting Works       | 2  |
|   | Old Dominion Copper Mining and Smelting Co., Smelter | 3  |
| P | Public School  | 1  |
| U | United Globe Mining Co., "Grey" Hoist                | 1  |
| W | Wingfield Storage Co.'s Stables                      | 7  |

