

JUNE 1893
PHOENIX
ARIZ.

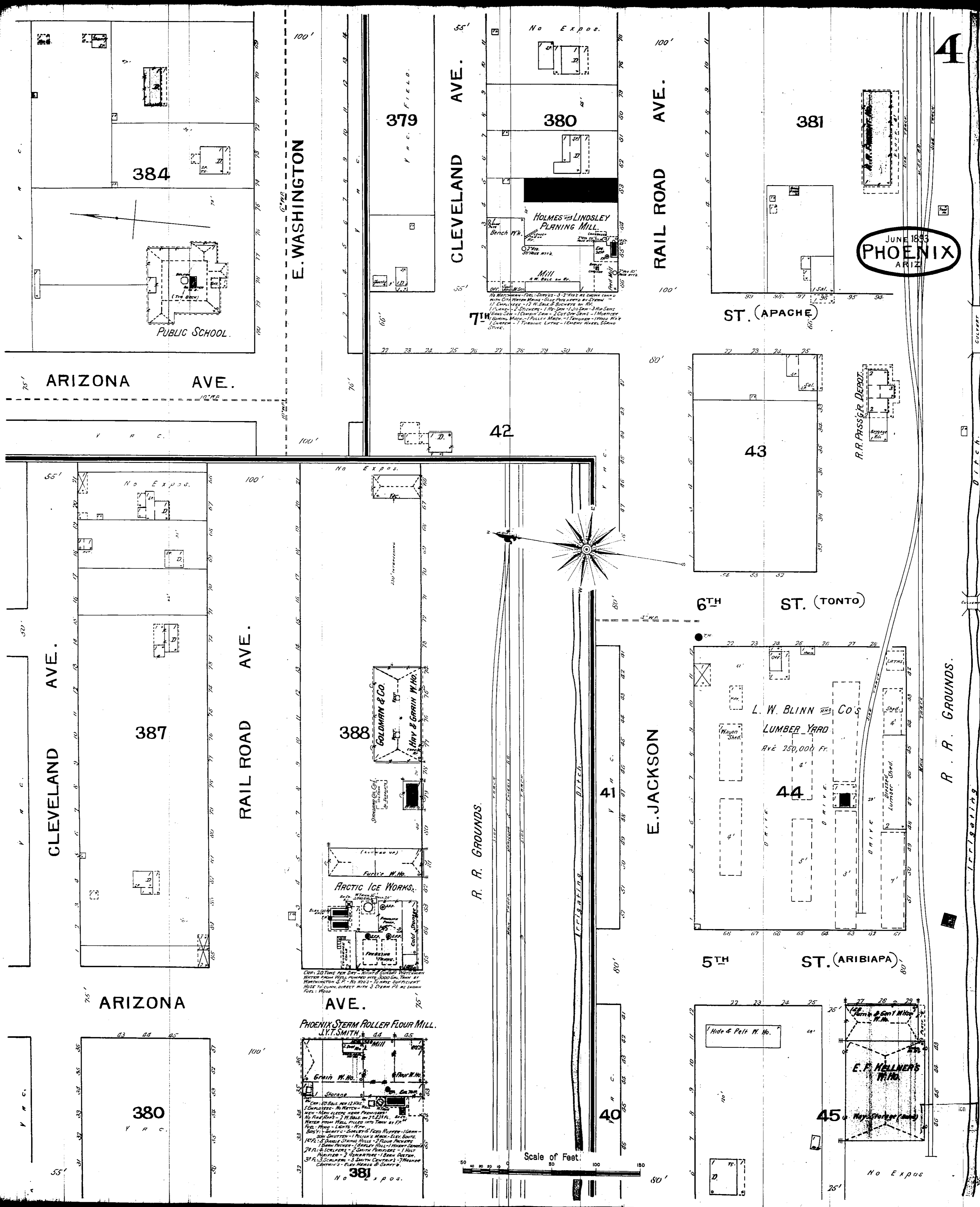

384

PUBLIC SCHOOL.

ARIZONA AVE.

CLEVELAND AVE.

387

ARIZONA

380

379

CLEVELAND AVE.

380

HOLMES AND LINDSLEY
PLANING MILL.

7TH

42

RAIL ROAD AVE.

381

ST. (APACHE)

43

R.R. PASSENGER DEPOT.

CLEVELAND AVE.

RAIL ROAD AVE.

388

ARCTIC ICE WORKS.

PHOENIX STEAM ROLLER FLOUR MILL.
J.T. SMITH

381

R.R. GROUNDS.

E. JACKSON

41

6TH ST. (TONTO)

L. W. BLINN & CO'S
LUMBER YARD
Ave 250,000 Ft.

44

5TH ST. (ARIBIAPA)

40

Scale of Feet.

45

E. F. MELLNER'S
MILL

No Expos